

THE DRAGON CHAMBER



# THE DRAGON CHAMBER

*An Immersive Hidden Restaurant*

Hidden behind the fridge door of an unassuming kopitiam, The Dragon Chamber is a hole-in-the-wall reminiscent of old-time Chinatown gambling dens and secret society hangouts. Serving guerrilla-style food that brings back age-old unconventional Chinese dishes, guests will be able to experience an adventurous gastronomic affair.





# THE DRAGON CHAMBER FLOOR PLAN

	Seated	Standing	Pricing
Total Capacity	120 pax	160 pax	Weekday Lunch (3 hours) \$7,000++ Dinner (4 hours) \$11,000++
			Weekend Dinner (4 hours) \$13,000++
Main Dining Room	52 pax	65 pax	Lunch (3 hours) \$4,000++ Dinner (4 hours) \$8,000++
Private Dining Room	36 pax	50 pax	Weekday Lunch (3 hours) \$3,000++ Dinner (4 hours) \$4,800++
			Weekend Dinner (4 hours) \$5,200++

**Facilities:**  
Screen Projector  
Microphone x 2

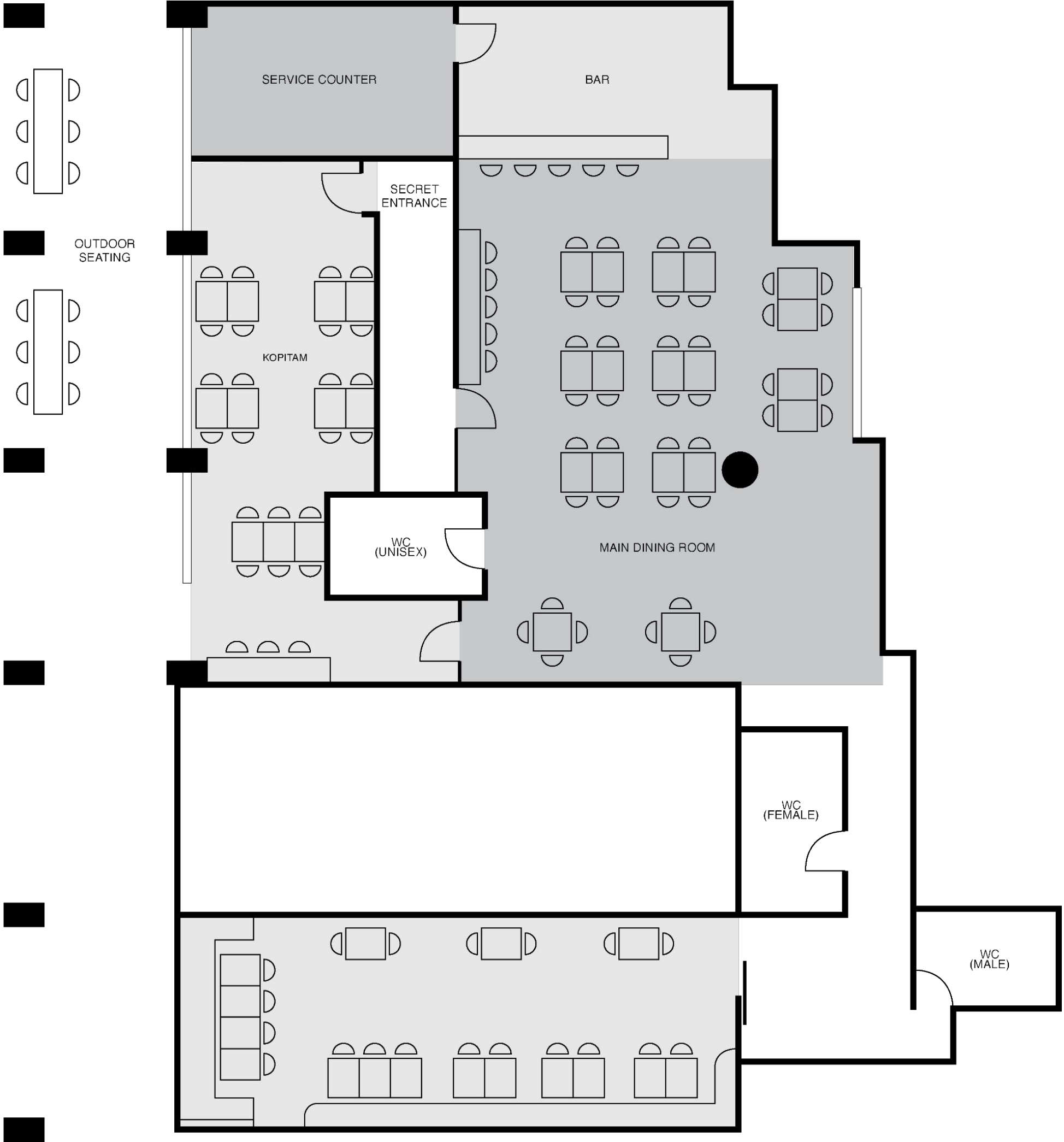













龍堡



# 龍堂









*Weddings at*  
**THE DRAGON CHAMBER**

---

龍堂



*Weddings at*  
**THE DRAGON CHAMBER**

---

*Our Food*

Our menu takes you on a bold and adventurous journey into the unexpected, offering unique spins on traditional comfort foods and guerrilla-style dishes that explode with flavours and textures. For your special day, a personalised menu will be tailored to your tastes and preferences with every dish crafted with exquisite care and attention to detail. Every bite will be a moment to savour and remember, ensuring that your celebration is truly indelible.





Our Partners

龍堂

BLISS  
FLOWER BOUTIQUE



27A

© EBB & FLOW GROUP



THE IVORY





EBB & FLOW  
GROUP

**May Wan**  
*Partnerships and Events Manager*  
+65 9181 9617  
[maywan.teh@ebbflowgroup.com](mailto:maywan.teh@ebbflowgroup.com)